

- SPECIFICATIONS**
- 1、Current Rating: 1A AC, DC
  - 2、Voltage Rating: 125V AC, DC
  - 3、Temperature Range: -25°C~+85°C
  - 4、Contact Resistance: 20mΩ Max
  - 5、Insulation Resistance: 100mΩ Min
  - 6、Withstanding Voltage: 500V AC/minute
  - 7、Material: Wafer Nylon46, UL94V-0  
PIN Phosphoric copper Tin-plated

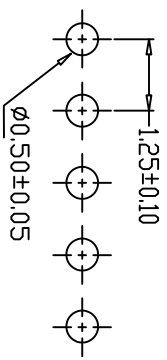
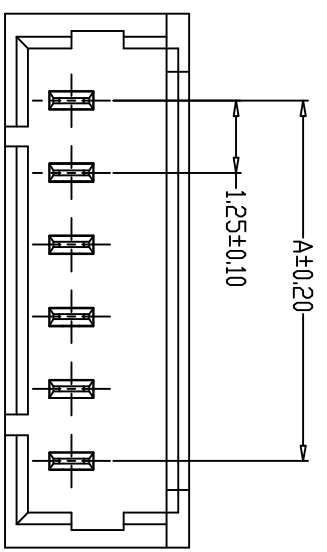
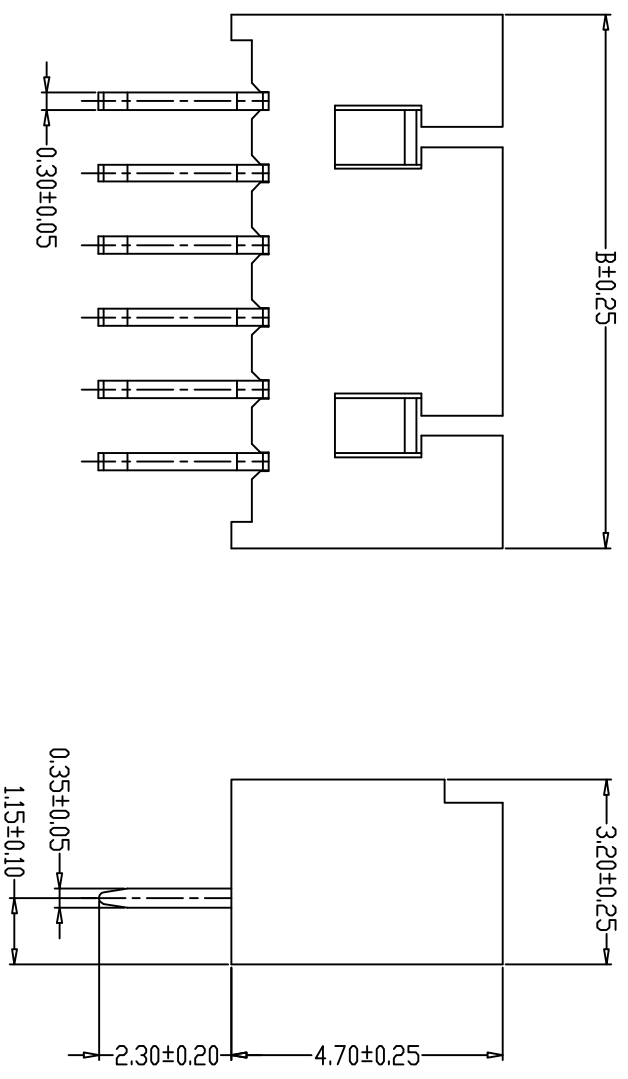

PCB LAYOUT

编 号	尺寸 (mm)	
	A	B
A1251WV-02A	1.25	4.25
A1251WV-03A	2.50	5.50
A1251WV-04A	3.75	6.75
A1251WV-05A	5.00	8.00
A1251WV-06A	6.25	9.25
A1251WV-07A	7.50	10.50
A1251WV-08A	8.75	11.75
A1251WV-09A	10.00	13.00
A1251WV-10A	11.25	14.25
A1251WV-11A	12.50	15.50
A1251WV-12A	13.75	16.75
A1251WV-15A	17.50	20.50

	单位 UNIT	mm
X. ±0.5	X. ±	
.X ±0.30	X. ±	
.XX ±0.20	.XX ±	
.XXX ±0.005	.XXX ±	

核准: APPROVED BY	版本: REV	产品名称 Product name	1.25开口直杆座
审核: CHECKED BY	页次: PAGE	产品编号 Product No	TH-A1251WV-NA
制图: DRAWN BY	日期: DATE	客户编号 Client No	

深圳市泰华电子有限公司  
**TaiHua Electronics Co., Ltd**

